

5th Annual Alarm Association of Greater St. Louis Golf Tournament At Pevely Farms

Pevely Farms is certainly one of the Midwest's finest courses. With breathtaking views and outstanding design that appeals to all skill levels, this course is a must play.

Experience it with us
on Tuesday October 6, 2009

We look forward to seeing you
there!



Pevely Farms Golf Club

400 Lewis Rd
St. Louis, Mo 63025
636.938.7000

DIRECTIONS

- From the intersection of I-44 and I-270:
- Go West on I-44
- Take I-44 West until the Lewis Rd Exit, number 266
- Take the Lewis Rd Exit and turn right onto Lewis Rd.
Lewis Rd becomes North Outer Rd East
- Turn Right onto S. Lewis Rd
- Go about 1 1/2 miles down and arrive at Pevely Farms Golf Club

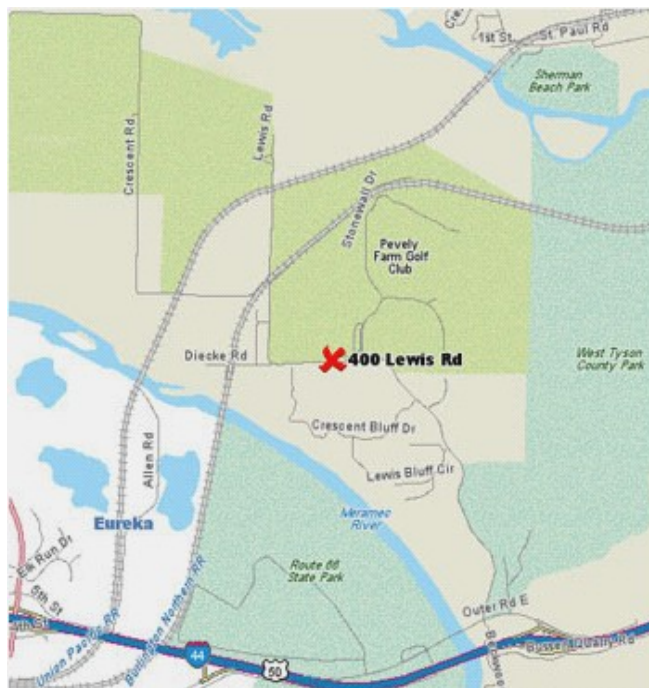

ALARM ASSOCIATION OF GREATER ST. LOUIS, INC.



5th Annual



Alarm Association of
Greater St. Louis
Golf Tournament
St. Louis, Inc.



**Tuesday,
October
6, 2009**

www.alarmstl.org

**Pevely Farms
Golf Club**

- **Pevely Farms Golf Club**

\$125 per player
\$500 per team
(four man scramble)
8:00AM Shotgun Start

PROMPT

Entry Fee Includes:

BBQ lunch, beverages,
snacks, cart and green fees, two free
drink tickets, complementary sleeve
of golf balls and tees, team picture
and chance for prizes.

- **Prizes:**

Lowest team score
Closest to the Pin
Longest Drive
Longest Putt

- BBQ, Hole in One, Lunch and awards following tournament.

- **Contact:**

Rick Drake
C/O American Burglary & Fire, Inc.
507 Rudder Road
Fenton, MO 63026
Direct: 636-600-4770
Fax: 636-680-9770

Deadline for Registration:
September 30

Mulligans & Skins For Sale!!!

See Rick Drake the
“Mulligan Man”

ENTRY FORM

Payment in the form of a check should be made payable to **The Alarm Association of Greater St. Louis, Inc**

Payment Enclosed:

Check Amount: \$ _____

Or Pay by Credit Card go to: www.alarmstl.org

Send Payment To : **AAGSL Interface**
ATTN: Rick Drake - Treasurer
C/O American Burglary & Fire, Inc.
507 Rudder Road
Fenton, MO 63026

Team \$500.00 or Individual Entry: \$125.00 per person

Captain Name: _____ Phone # _____

Player Two : _____

Player Three: _____

Player Four: _____

***** Sponsors Needed *** Please Check All That Apply *****

_____ Yes I will sponsor a team of four for \$500
_____ Yes I will sponsor a hole for \$100
_____ Yes I will sponsor a beverage cart for \$200
_____ Yes I will donate a door or raffle prize
_____ Yes I will donate a prize for closest to the pin for \$100
_____ Yes I will donate a prize for longest drive for \$100

★New!! Go to AAGSL Website to pay by Credit Card★

Sponsor Name _____

Sponsor Phone # _____

Sponsor Address _____

www.alarmstl.org